



Model: KCHMT48.18

PNC: 738260

REV: 4/12/2024

Spare Parts List

NO	DESCRIPTION	Serial #	QTY	COMPONENT PNC	Model Number	Model PNC
2	TEMPERATURE CONTROLLER	2005211Z	1PC	0USF42	KCHMT48.18	738260
		2005211Z	1PC	0USDET	KCHMT48.18	738260
2a	Inner Chest Temperature Sensor Probe	ALL	1PC	0USC4C	KCHMT48.18	738260
2b	Controller Mounting Plate	ALL	1PC	0USDIF	KCHMT48.18	738260
8	CABLE COVER	ALL	1PC	0USK07	KCHMT48.18	738260
9	BRAKE WHEEL	ALL	2PCS	0USF03	KCHMT48.18	738260
10	FRONT SUPPORT OF UNIT BOARD	ALL	1PC	0USJ59	KCHMT48.18	738260
11	NORMAL WHEEL	ALL	2PCS	0USH63	KCHMT48.18	738260
11a	Castor Mounting Bolt (4-PACK)	ALL	4PC	0USC2U	KCHMT48.18	738260
11b	Castor Mounting Locking Washer (4-PACK)	ALL	4PC	0USC4A	KCHMT48.18	738260
11c	Castor Mounting Flat Washer (4-PACK)	ALL	4PC	0USC2X	KCHMT48.18	738260
12	BACK SUPPORT OF UNIT BOARD	ALL	1PC	0USJ60	KCHMT48.18	738260
13	DOOR HINGE/RIGHT	ALL	1PC	0USF81	KCHMT48.18	738260
14	BODY	ALL	1PC	N/A	KCHMT48.18	738260
15	TOP CLIP	ALL	4PCS	0USL80	KCHMT48.18	738260
16	UNIT ROOM COVER	ALL	1PC	0USI14	KCHMT48.18	738260
17	PLUG	ALL	1PC	0USH67	KCHMT48.18	738260
18	LOCATION KNOB	ALL	2PCS	0USH46	KCHMT48.18	738260
19	FIXED PIN OF CUTTING BOARD	ALL	2PCS	0USG68	KCHMT48.18	738260
20	TOP	ALL	1PC	0USM90	KCHMT48.18	738260
21	CUTTING BOARD	ALL	1PC	0USM91	KCHMT48.18	738260
22	PAN SUPPORT /FRONT	ALL	1PC	0USM92	KCHMT48.18	738260
22a	PAN SUPPORT /BACK	ALL	1PC	0USDEH	KCHMT48.18	738260
23	STANDARD PAN	ALL	18PCS	N/A	KCHMT48.18	738260
24	PAN SUPPORT /LEFT/RIGHT	ALL	2PCS	0USJ32	KCHMT48.18	738260
25	PAN SUPPORT	ALL	5PCS	0USJ31	KCHMT48.18	738260
26	HANDLE OF COVER	ALL	1PC	0USH09	KCHMT48.18	738260
27	MOVING COVER	ALL	1PC	0USM93	KCHMT48.18	738260
27a	MOVING COVER LINER	ALL	1PC	0USL46	KCHMT48.18	738260
28	FIXED COVER	ALL	1PC	0USM94	KCHMT48.18	738260
28a	FIXED COVER LINER	ALL	1PC	0USL71	KCHMT48.18	738260
29	CONDENSER	ALL	1PC	0USF34	KCHMT48.18	738260
30	FILTER DRIER	ALL	1PC	0USG66	KCHMT48.18	738260
30a	CAPILLARY	ALL	1PC	0USM13	KCHMT48.18	738260
31	DRIER SUPPORT	ALL	1PC	0USI78	KCHMT48.18	738260
33	CONDENSER FAN	ALL	1PC	0USF40	KCHMT48.18	738260
33a	CONDENSER FAN BLADE	ALL	1PC	0USC4J	KCHMT48.18	738260
34	Basket Guard Grills	ALL	1PC	0USDIJ	KCHMT48.18	738260
35	EVAPORATE PIPE	ALL	1PC	0USG14	KCHMT48.18	738260
36	WATER BOX	ALL	1PC	0USI29	KCHMT48.18	738260
37	COMPRESSOR	ALL	1PC	0USF28	KCHMT48.18	738260
37a	COMPRESSOR ELECTRICAL COMPONENT SET	ALL	1PC	0USDF5	KCHMT48.18	738260
38	SUCTION PIPE	ALL	1PC	0USM95	KCHMT48.18	738260
39	CONNECTOR SUPPORT	ALL	1PC	0USDEE	KCHMT48.18	738260
40	CABLE CONNECTION	ALL	1PC	0USF09	KCHMT48.18	738260
41	CONNECTOR COVER	ALL	1PC	0USJ98	KCHMT48.18	738260
42	GUIDE OF UNIT BOARD/LEFT	ALL	1PC	0USK50	KCHMT48.18	738260

42a	GUIDE OF UNIT BOARD/RIGHT	ALL	1PC	OUSK49	KCHMT48.18	738260
43	UNIT BOARD	ALL	1PC	OUSK32	KCHMT48.18	738260
45	CIRCLE FAN	ALL	3PCS	OUSF14	KCHMT48.18	738260
46	CIRCLE FAN SUPPORT	ALL	1PC	OUSL22	KCHMT48.18	738260
47	EVAPORATOR	ALL	1PC	OUSM96	KCHMT48.18	738260
47a	Evaporator Temperature Sensor Probe	ALL	1PC	OUSC6R	KCHMT48.18	738260
48	EVAPORATOR WATER PAN	ALL	1PC	OUSG59	KCHMT48.18	738260
49	FIXED SUPPORT OF EVAPORATOR COVER	ALL	2PCS	OUSK05	KCHMT48.18	738260
50	EVAPORATOR COVER	ALL	1PC	OUSL23	KCHMT48.18	738260
52	SENSOR FIXED CLIP	ALL	1PC	OUSM10	KCHMT48.18	738260
53	SHELF SUPPORT B	ALL	4PCS	OUSI66	KCHMT48.18	738260
53a	Shelf Support Screw	ALL	8PCS	OUSM14	KCHMT48.18	738260
54	SHELF	ALL	2PCS	OUSCOM	KCHMT48.18	738260
55	SHELF SUPPORT A	ALL	4PCS	OUSI44	KCHMT48.18	738260
55a	Shelf Support Screw	ALL	12PCS	OUSM14	KCHMT48.18	738260
56	K SHAPE CLIP	ALL	8PCS	USH19	KCHMT48.18	738260
57	UP HINGE/LEFT	ALL	1PC	OUSI16	KCHMT48.18	738260
58	UP HINGE /RIGHT	ALL	1PC	OUSI17	KCHMT48.18	738260
59	BUSHING	ALL	2PCS	096268	KCHMT48.18	738260
60	GASKET	ALL	2PCS	USH00	KCHMT48.18	738260
61	DOOR/LEFT	ALL	1PC	OUSM97	KCHMT48.18	738260
61a	DOOR /RIGHT	ALL	1PC	OUSM98	KCHMT48.18	738260
62	DOOR SPRING HINGE	ALL	2PCS	OUSF83	KCHMT48.18	738260
63	CONDUCT BOARD	ALL	1PC	OUSN00	KCHMT48.18	738260
63a	CONDUCT BOARD SIDE PLATE	ALL	2PCS	OUSL14	KCHMT48.18	738260
64	DOOR HINGE/LEFT	ALL	1PC	OUSF80	KCHMT48.18	738260
65	MIDDLE GIRDER	ALL	1PC	OUSC6D	KCHMT48.18	738260
66	MIDDLE GIRDER FIXER	ALL	2PCS	USH59	KCHMT48.18	738260
67	FIXED BOLT	ALL	2PCS	OUSG67	KCHMT48.18	738260
68	FIXED NUT	ALL	2PCS	OUSG73	KCHMT48.18	738260

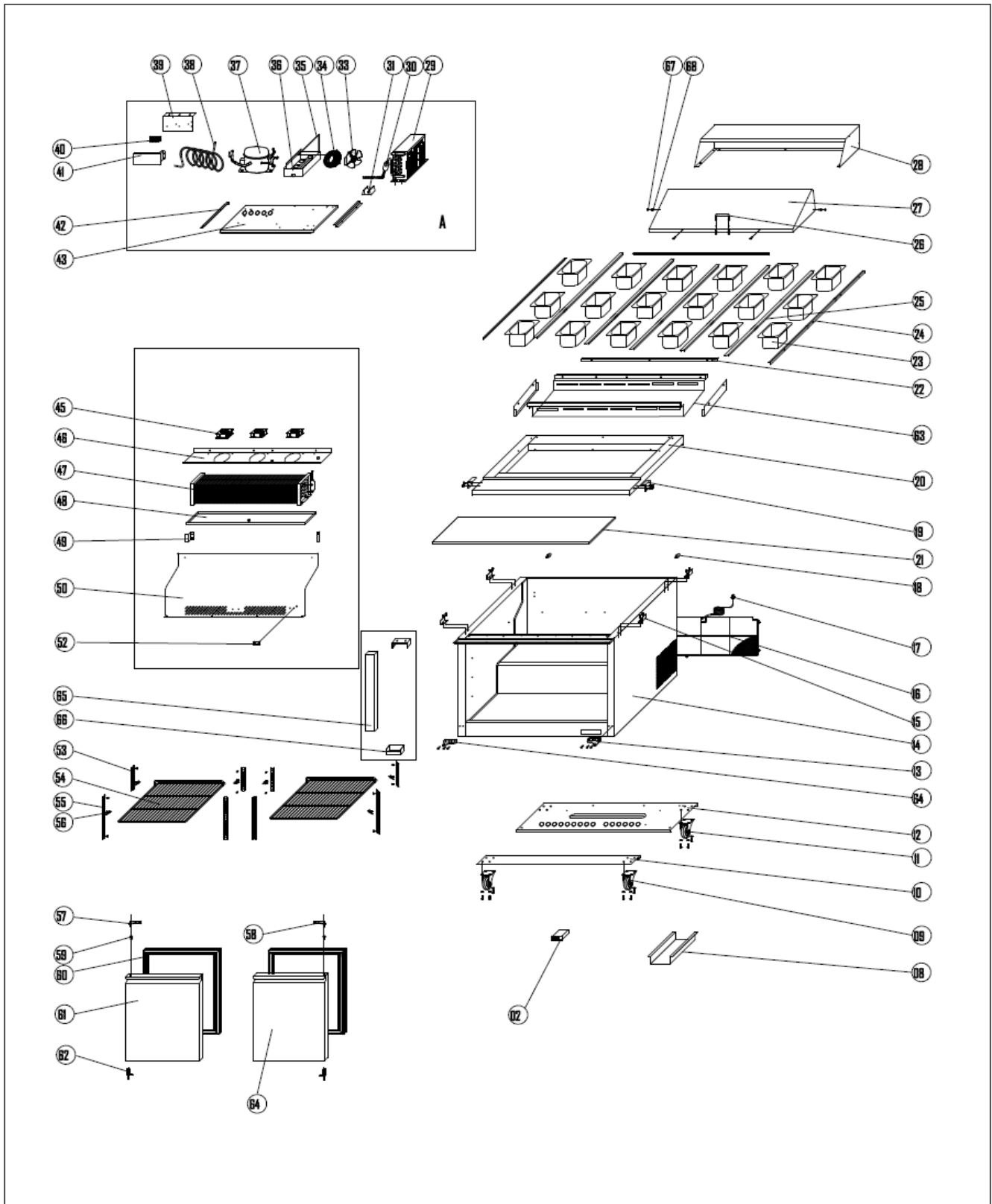

EXPLODE OF KCHMT48.18